

GB/T1804—2000

2016-08-31

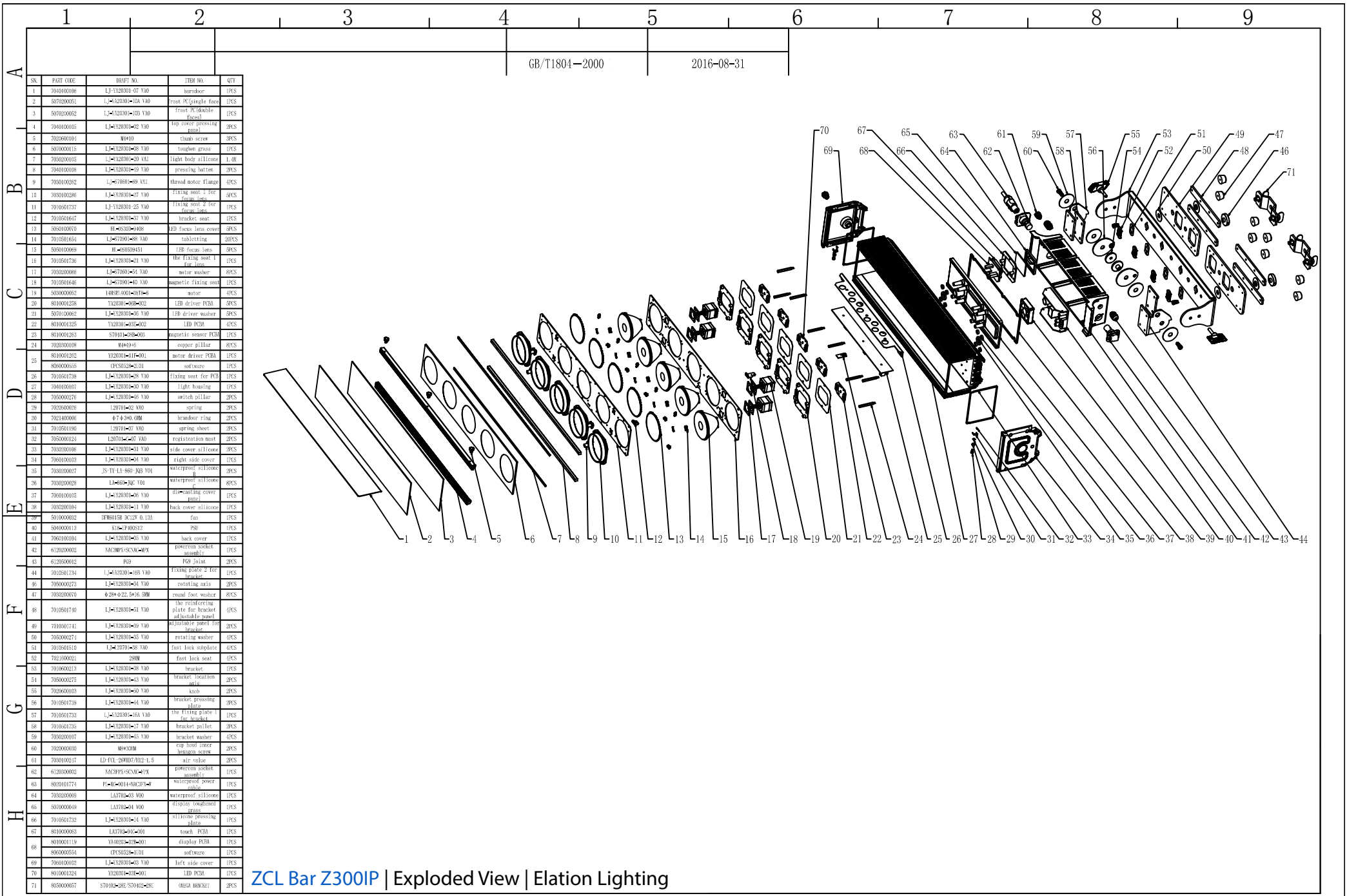

SN	PART CODE	REF NO.	TRF NO.	QTY
1	704010006	LJ-120301-07 VAO	housdoor	1PCS
2	507000051	LJ-120301-0A VAO	front PC(single face)	1PCS
3	507000052	LJ-120301-0B VAO	front PC(double face)	1PCS
4	704010005	LJ-120301-02 VAO	top cover mounting plate	2PCS
5	702000101	M10*10	thumb screw	3PCS
6	500000115	LJ-120301-08 VAO	toughen glass	1PCS
7	703001005	LJ-120301-20 VAL	light body silicone	1.0M
8	704010108	LJ-120301-19 VAO	pressing button	2PCS
9	703010052	LJ-120301-09 VAL	flared motor flange	4PCS
10	703010298	LJ-120301-07 VAO	fixing seat 1 for fixing lens	2PCS
11	703010737	LJ-120301-25 VAO	fixing seat 2 for fixing lens	1PCS
12	703010447	LJ-120301-07 VAO	bracket seat	1PCS
13	505010000	H-8030-108	ED focus lens cover	2PCS
14	703010551	LJ-120301-08 VAO	tabbletting	20PCS
15	505010009	H-8030-1451	LED focus lens	2PCS
16	703010736	LJ-120301-01 VAO	the fixing seat 1 for lens	1PCS
17	703010086	LJ-120301-01 VAO	motor washer	8PCS
18	703010146	LJ-120301-00 VAO	magnetic fixing seat	1PCS
19	503000052	H8030-001-0116-6	motor	4PCS
20	801001258	Y32031-008-002	LED driver PCB	2PCS
21	507010002	LJ-120301-06 VAO	LED driver washer	2PCS
22	801001325	Y32031-003-002	LED PCB	4PCS
23	801001283	ST0101-008-001	magnetic sensor PCB	1PCS
24	703000108	M10*10	screw pillar	8PCS
25	801001282	Y32031-011-001	motor driver PCB	1PCS
26	800000055	CP30522-011	software	1PCS
27	703010738	LJ-120301-00 VAO	fixing seat for PCB	1PCS
28	704010107	LJ-120301-00 VAO	light housing	1PCS
29	705000076	LJ-120301-06 VAO	switch pillar	2PCS
30	705000058	120701-00 VAO	spring	2PCS
31	702140006	4*4-360-09M	brandon ring	2PCS
32	703010140	120701-07 VAO	spring sheet	2PCS
33	705000124	120701-07 VAO	resistation mast	2PCS
34	703010106	LJ-120301-01 VAO	side cover silicone	2PCS
35	704010103	LJ-120301-04 VAO	right side cover	1PCS
36	703010057	JS-11-12-889-109 V01	waterproof silicone	2PCS
37	703010028	LJ-120301-01 VAO	waterproof silicone	4PCS
38	704010105	LJ-120301-06 VAO	fixing cover plate	1PCS
39	703020104	LJ-120301-11 VAO	back cover silicone	1PCS
40	501000052	DF8618B-D129-0.13A	fan	1PCS
41	501000113	K11-P406312	PSU	1PCS
42	706010104	LJ-120301-05 VAO	back cover	1PCS
43	613000002	M3CP3-SCM-6FX	potterton socket assembly	1PCS
44	613000012	PS9	PS9 fan	2PCS
45	703010734	LJ-120301-09 VAO	fixing plate 2 for bracket	1PCS
46	703000073	LJ-120301-04 VAO	rotating axis	2PCS
47	703020009	Φ20*Φ22.5*18-30M	round fast washer	8PCS
48	703010140	LJ-120301-01 VAO	the reinforcing plate for bracket adjustable panel	1PCS
49	701001741	LJ-120301-09 VAO	rotating seat for bracket	2PCS
50	705000071	LJ-120301-05 VAO	rotating washer	4PCS
51	703010110	LJ-120701-08 VAO	fast lock subplate	4PCS
52	702100021	29M	fast lock seat	1PCS
53	703000013	LJ-120301-08 VAO	bracket	1PCS
54	705000075	LJ-120301-13 VAO	bracket potterton socket	2PCS
55	703000103	LJ-120301-00 VAO	knob	2PCS
56	703010738	LJ-120301-14 VAO	bracket pressing plate	2PCS
57	703010732	LJ-120301-16A VAO	the fixing plate 1 for bracket	1PCS
58	703010735	LJ-120301-17 VAO	bracket pillar	2PCS
59	703010107	LJ-120301-05 VAO	bracket washer	1PCS
60	703000050	M10*10	top cover inner hexagon screw	2PCS
61	703010027	LD-FLL-30M07/012-1.5	air valve	2PCS
62	613000002	M3CP3-SCM-6FX	potterton socket assembly	1PCS
63	803010174	F-01-0014-M3CP3-6	waterproof power cable	1PCS
64	703020009	LA3702-03 V00	waterproof silicone	1PCS
65	501000049	LA3702-01 V00	display touchsened glass	1PCS
66	703010732	LJ-120301-14 VAO	silicone pressing plate	1PCS
67	801000083	LA3702-01-001	touch PCB	1PCS
68	801000119	Y34031-001-001	display PCB	1PCS
69	800000054	CP30522-11.01	software	1PCS
70	706010102	LJ-120301-03 VAO	left side cover	1PCS
71	801001324	Y32031-001-001	LED PCB	1PCS
72	803000057	ST0102-38/ST0102-28C	OMEGA BAR/RET	2PCS

ZCL Bar Z300IP | Exploded View | Elation Lighting